

Self-drilling screw JT3-6-6.3



Cross references

Cordless screwdriver ASCM QSW
Socket wrench insert SW8

Application range

- > Fastening profiled steel sheets to 2-5 mm steel substructure

Properties

- > A2 stainless steel with hardened steel drill point
- > Stainless steel sealing washer
- > Pre-assembled sealing washer

Applications

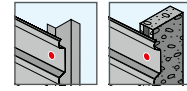

Technical specifications

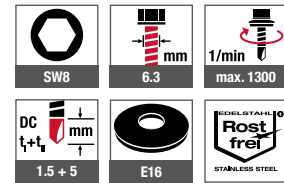

Certifications



Installation process



Product online



Order description	Length [mm]	Clamping thickness [mm]	PU [pieces]	Price/100 [EUR]	Article number	EAN
Sealing washer E16, Ø 16 mm						
JT3-6-6.3x25-E16	25	0-7	500		3599411361	4061245036847